

Central Brass®

The Easy Choice

2950 East 55th St. Cleveland, Ohio 44127
Phone: (216) 883-0220 Fax: (216) 883-0875
www.CentralBrass.com

MODEL NO. 0126-A
KITCHEN TOPMOUNT

The 6-inch center topmounted kitchen faucet has a cast brass body that is copper, nickel and chrome plated. The compression stems are all brass with a double O-Ring seal and rubber seat washer. The canopy handles are zinc die cast with a chrome plated finish. The 8-inch swivel spout is brass with a chrome plated finish and is fitted with a water saving aerator that limits the flow rate. The O-Rings and seals are rubber. The faucet has a spray rinse attachment that is connected with a 48-inch nylon hose with a chrome plated hose guide.

Flow Rate: 2.2 GPM @ 60 psi
ADA Compliant and Meets ASME A112.18.1M
ANSI/NSF 61/Section 9 Certified

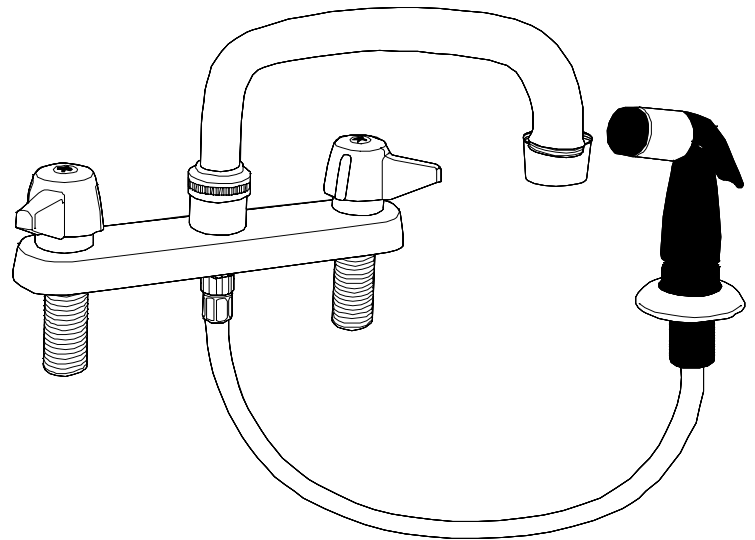

Installation Drawing

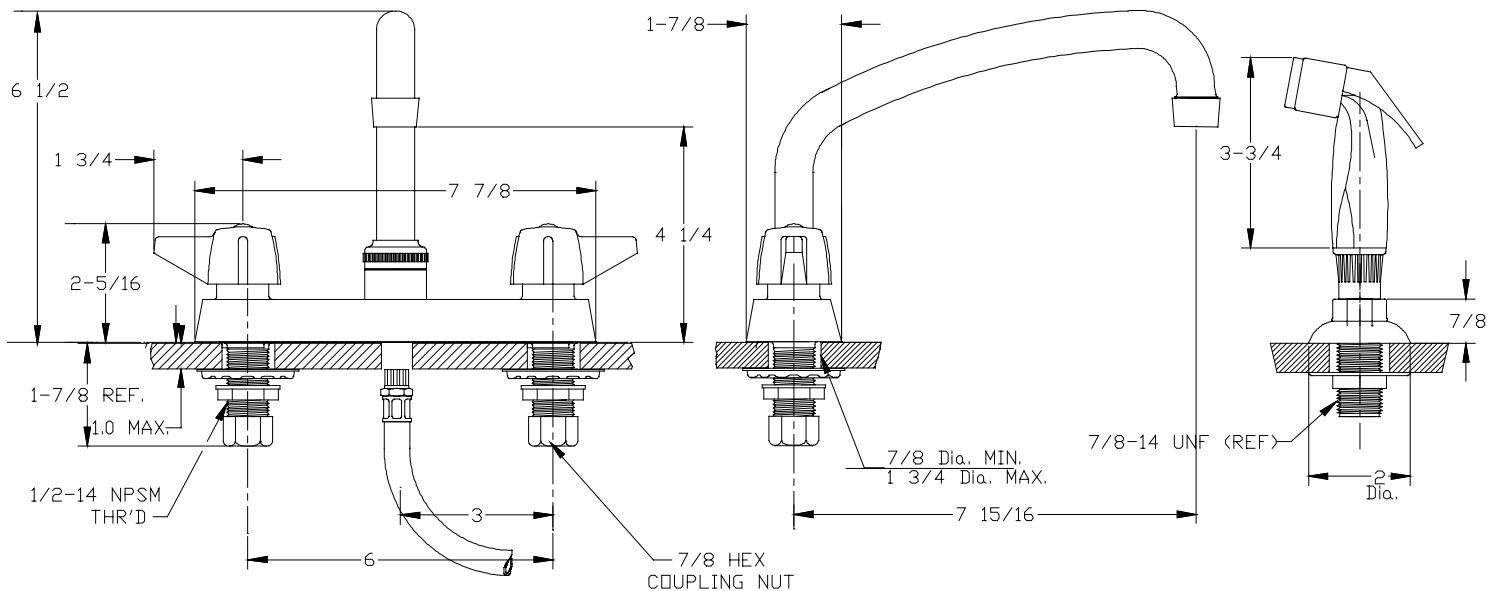

Central Brass®

The Easy Choice
 2950 East 55th St. Cleveland, Ohio 44127
 Phone: (216) 883-0220 Fax: (216) 883-0875
 www.CentralBrass.com

MODEL NO. 0126-A KITCHEN TOPMOUNT

Suffix Options & Accessories

Handle variations available

Villager Lever

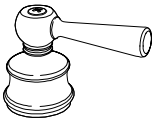

K-512-02 (chrome)
 K-512-15 (white)

Brass Lever

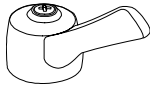

G-1143-C (cold)
 G-1143-H (hot)

Wrist 4-inch

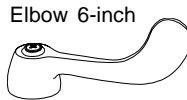

G-4147 (4-inch)
 G-4149 (6-inch)

Elbow 6-inch

Acrylic



G-506-1C (cold)
 G-506-1H (hot)

Silver Crown
 Acrylic



G-504-1C (cold)
 G-504-1H (hot)



Faucets with lever, wrist or elbow handles with compression or ceramic stem cartridges are ADA compliant.

Spout variations available

- A2 - Suffix
 10-inch Brass Tube Spout
- A3 - Suffix
 12-inch Brass Tube Spout
- A4 - Suffix
 14-inch Brass Tube Spout

Wall Mount
 Spout Adaptor
 Accessory

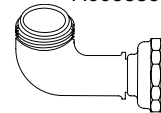

G-1748-88W

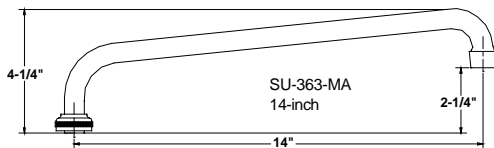

Cast Brass
 Spout Extension
 Accessory



NSF Drinking water products tested and certified by NSF International to ANSI/NSF Standard 61, Section 9. Each product required to meet the standard proudly exhibits the NSF logo.

Central Brass®

The Easy Choice

2950 East 55th St. Cleveland, Ohio 44127
 Phone: (216) 883-0220 Fax: (216) 883-0875
 www.CentralBrass.com

MODEL NO. 0126-A
KITCHEN TOPMOUNT

Parts Breakdown

#	Part#	Description
1	4015-BAR	Brass Coupling Nut
2	7133-AZ	Zinc Dichromate Locknut
3	54	Steel Crowfoot Washer
4	2158-AN	Brass Faucet Body
5	263-BC	Bronze Seat
6	1028-Y	Nylon Gasket
7	104	Brass Seat Washer Screw
8	901-WN	Seat Washer
9	453-FL	Brass Left Thread O-Ring Stem
9	453-FR	Brass Right Thread O-Ring Stem
10	1038-453	O-Ring

#	Part#	Description
11	453-EWC	Brass Left Thread O-Ring Bonnet
11	453-EWH	Brass Right Thread O-Ring Bonnet
12	523-C	Handle Indexed "C"
12	523-H	Handle Indexed "H"
13	107-F	Brass Phillips Head Screw
14	1038-IN	O-Ring
15	266-AD	Diverter Adapter
16	266-D	Diverter
17	266-S	Diverter Seal
18	266-C	Diverter Casing
19	1038-DIV	O-Ring
20	1038-KN	O-Ring
21	166-FN	Stainless Steel Snap Ring
22	PF-782-DES	Brass Spout Nut
23	PF-363-RA	Brass Swivel Spout
24	30-M	Female Aerator
25	SU-453-EL	Left Thread O-Ring Stem Assembly
25	SU-453-ER	Right Thread O-Ring Stem Assembly
26	266-A	Hose & Spray
27	SU-2987-DA	Hose Guide

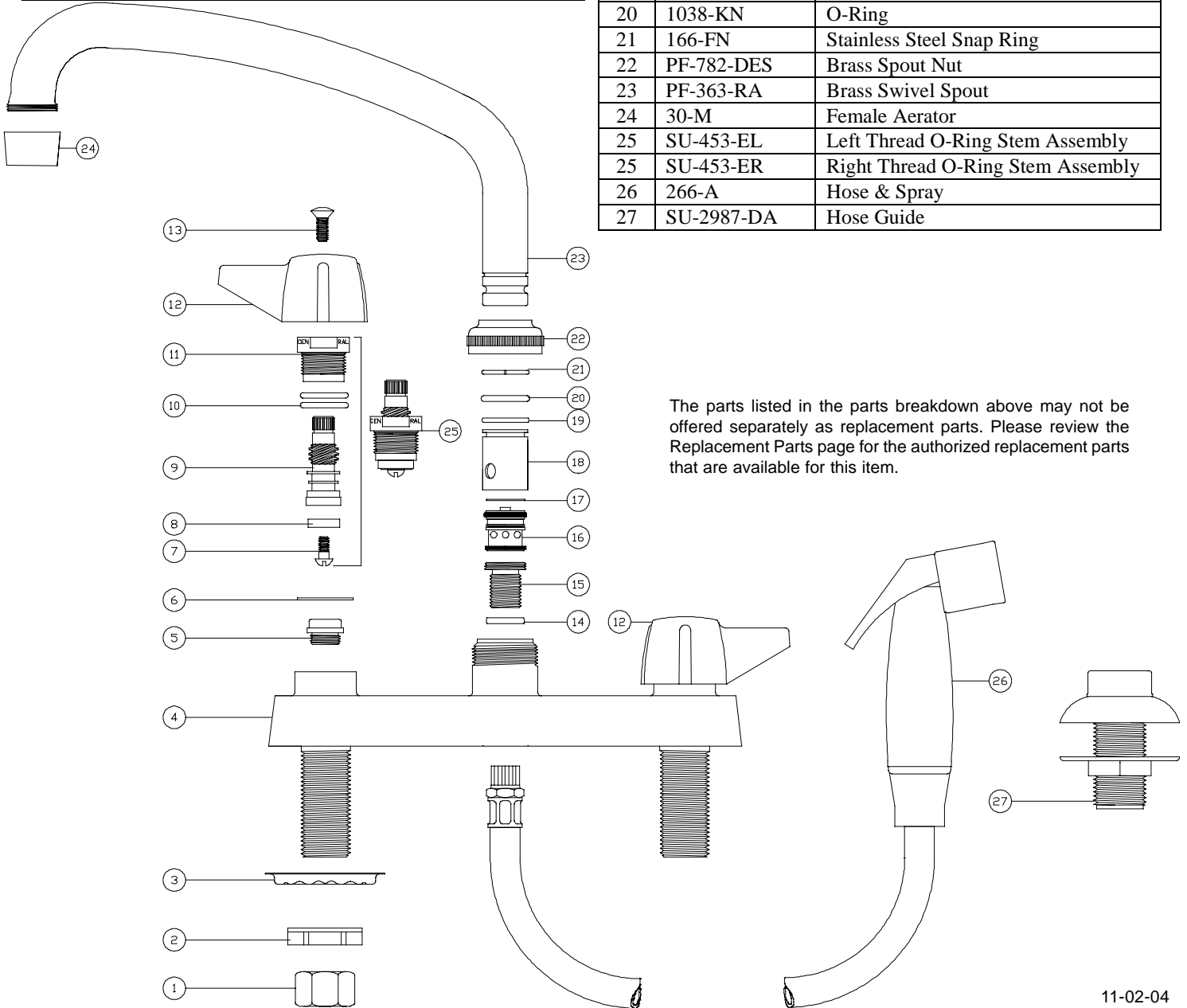

The parts listed in the parts breakdown above may not be offered separately as replacement parts. Please review the Replacement Parts page for the authorized replacement parts that are available for this item.